

V01	April 2022	PLANNING ISSUE	RCA	LAN	CCH
REV.	DATE	DESCRIPTION	PRODUCED BY	REVIEWED BY	APPROVED BY

© Irish Rail (2022). This drawing is confidential and the copyright in it is owned by Irish Rail. This drawing must not be either loaned, copied or otherwise reproduced in whole or in part or used for any purpose without the prior permission of Irish Rail.
 © Ordnance Survey Ireland and Government of Ireland. All O.S. data used for plans are printed under "Copyright Ordnance Survey Ireland".
 Survey No. 6039720 (OSI Aerial Data or OSI LIDAR Data) & Survey No. 202005_NMA_190 (OSI Vector Data).
 All elevations are in metres and relate to OSi Geoid Meansea (OSGM02) Mean Head as defined by existing Project Control.
 All Co-ordinates are in Irish Transverse Mercator Grid (ITM) as defined by OSi active GPS station Tallaght College (TLG19).

Client: Tionscaldal Éireann Project Ireland 2040, NTA Údarás Náisiúnta Iomparáil National Transport Authority

Consultant: IDOM, G3, IROD

Project: DART+ West

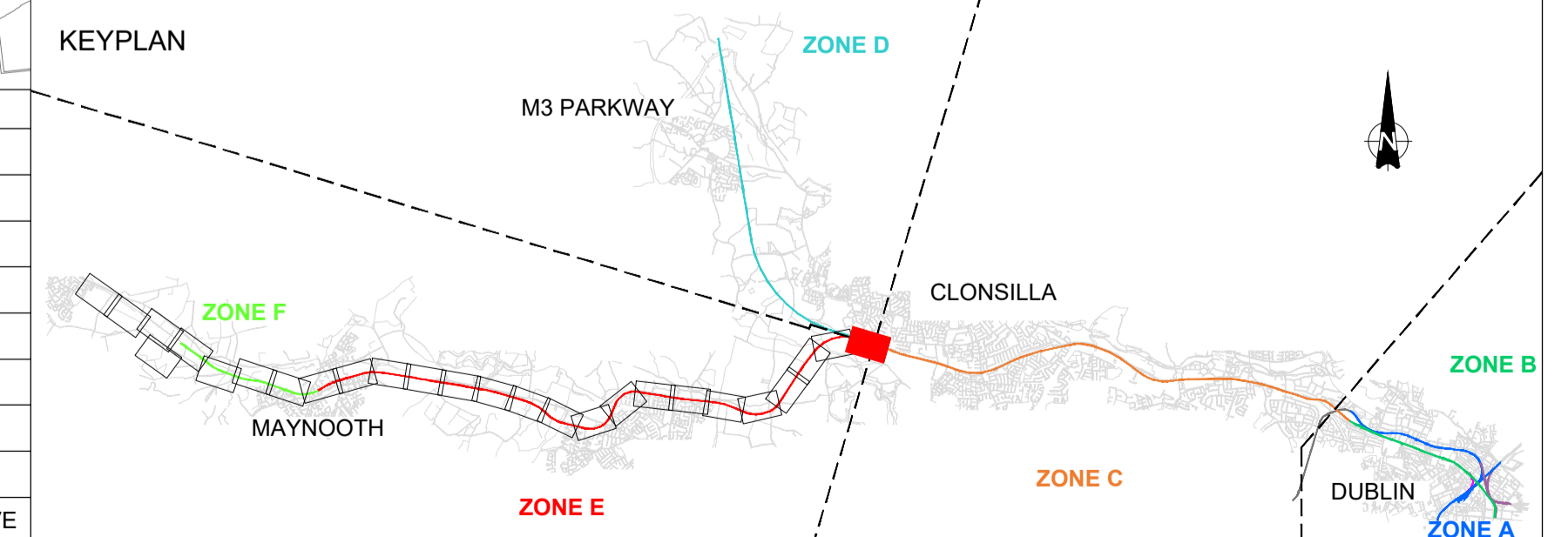

Drawing Title		PROJECT GENERAL LAYOUT SITE CLEARANCE ZONE E & F CLONSILLA JCT TO MAYNOOTH DEPOT									
Scale:	1:1000 @ A1	1:2000 @ A3	Drawing Number	Project	Originator	Discipline	Location	Type	Role	Number	Phase
Date:	April 2022	Job No:	P/101086	Status:	F1-Approved & accepted	Rev:	V01	Sheet:	1 of 26		

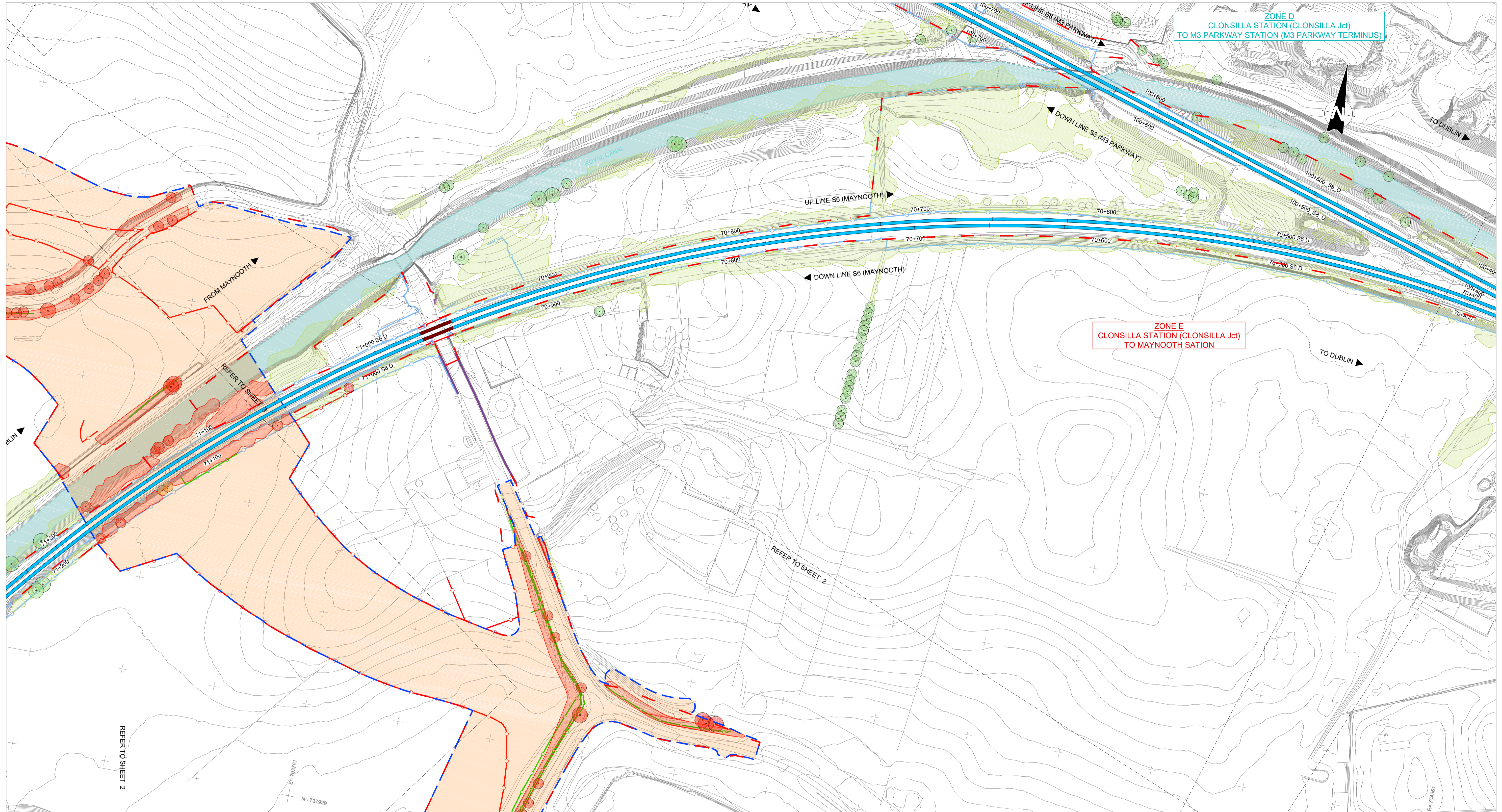

LEGEND SITE CLEARANCE			
	PROPOSED OVERBRIDGE / UNDERBRIDGE		EXISTING GATE TO BE REMOVED
	RECONSTRUCTED OVERBRIDGE / UNDERBRIDGE		EXISTING WALL
	OVERBRIDGE / UNDERBRIDGE TO BE DEMOLISHED		FENCES EXISTING
	OVERBRIDGE / UNDERBRIDGE / CULVERTS		FENCES PROJECTED
	TREE or VEGETATION EXISTING		FENCES REMOVED
	TREE or VEGETATION TO BE MAINTAINED		BUILDING TO BE DEMOLISHED
	TREE or VEGETATION TO BE REMOVED		RUNNING LINES/P&C NO CHANGES
	DEVELOPMENT BOUNDARY		PROPOSED SLAB TRACK
	GENERAL SITE CLEARANCE		RUNNING LINES/P&C TO SLEW/REMOVE

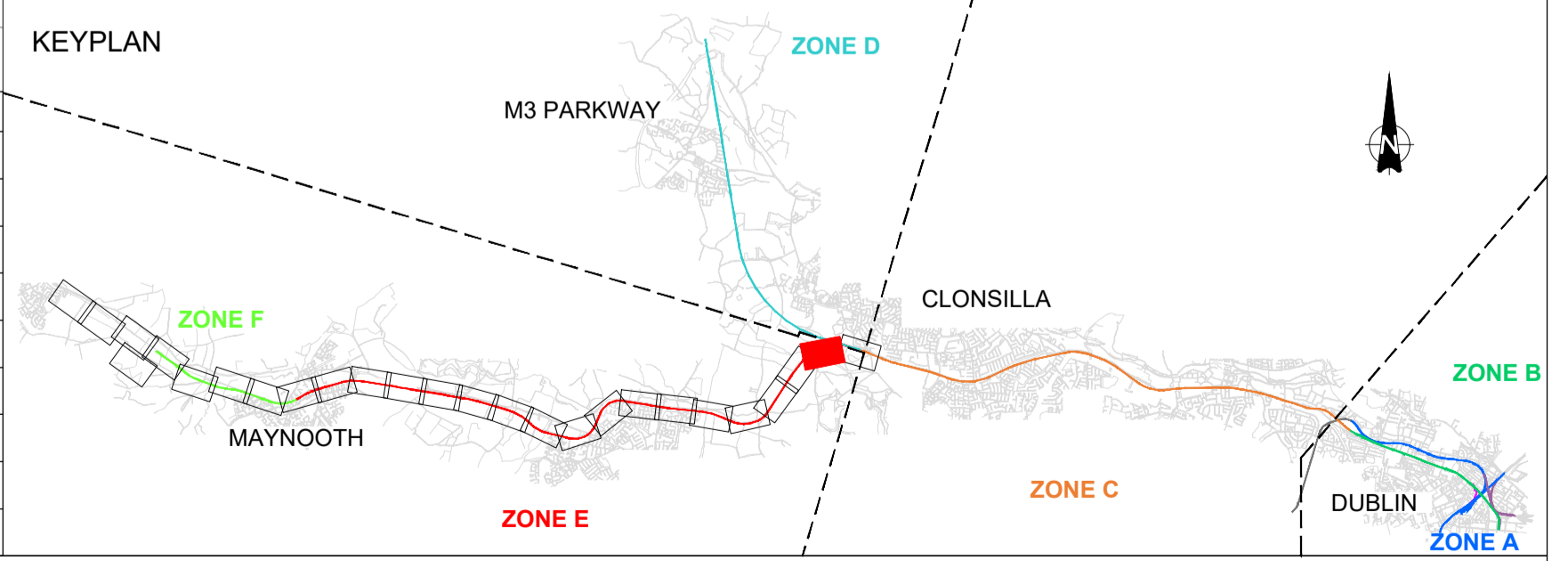

V01	April 2022	PLANNING ISSUE	RCA	LAN	CCH
REV.	DATE	DESCRIPTION	PRODUCED BY	REVIEWED BY	APPROVED BY

© Irish Rail (2022). This drawing is confidential and the copyright in it is owned by Irish Rail. This drawing must not be either loaned, copied or otherwise reproduced in whole or in part or used for any purpose without the prior permission of Irish Rail.
 © Ordnance Survey Ireland and Government of Ireland. All O.S. data used for plans are printed under "Copyright Ordnance Survey Ireland".
 Survey No. 0039720 (OSi Aerial Data or OSi Lidar Data) & Survey No. 2020051_NMA_180 (OSi Vector Data).
 All elevations are in metres and relate to OSi Geoid Mean (OSGM02) Mean Head as defined by existing Project Control.
 All Co-ordinates are in Irish Transverse Mercator Grid (ITM) as defined by OSi active GPS station Tallaght College (TLG9).

Client

Tionscatal Éireann
Project Ireland
2040

NTA
Údarás Náisiúnta Iompartha
National Transport Authority

lanróid Éireann
Irish Rail

Consultant

IDOM

G3

PROUD

ROUGHAN & O'DONOVAN

Project

DART+
West

Drawing Title

PROJECT GENERAL LAYOUT
SITE CLEARANCE ZONE E & F
CLONSILLA JCT TO MAYNOOTH DEPOT

Scale:
1:1000 @ A1 1:2000 @ A3

Drawing Number | Project | Originator | Discipline | Location | Type | Role | Number | Phase
MAY MDC LMA SC06 DR Y 0001 D

Date: April 2022 | Job No: P/101086 | Status: Ft-Approved & accepted | Rev: V01 | Sheet: 2 of 26

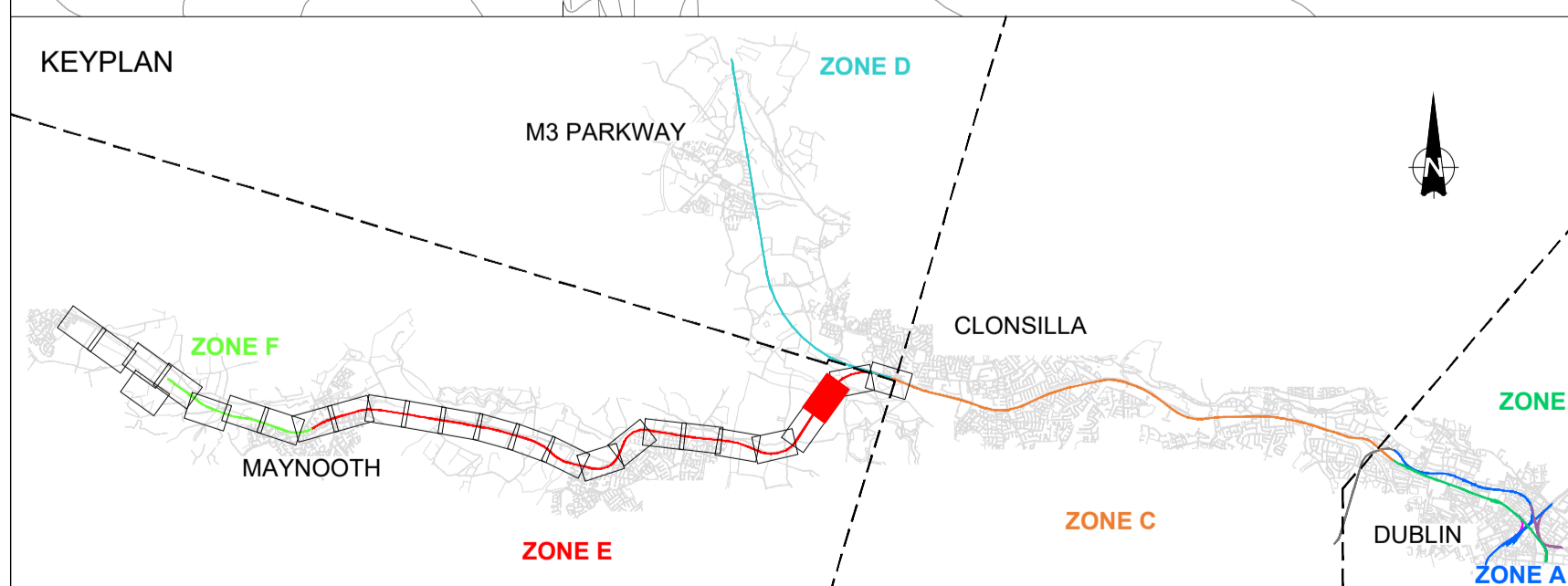
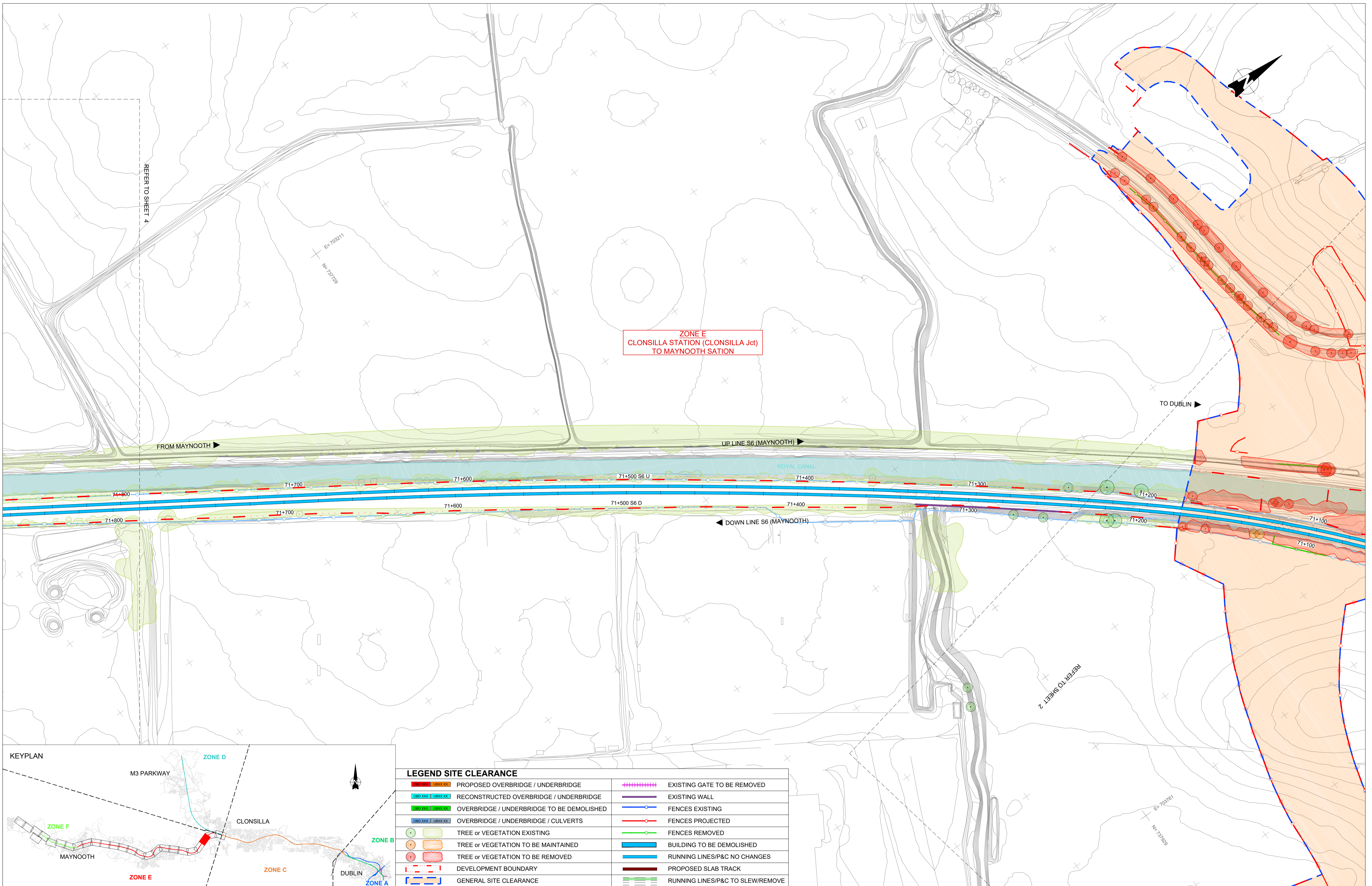

LEGEND SITE CLEARANCE			
	PROPOSED OVERBRIDGE / UNDERBRIDGE		EXISTING GATE TO BE REMOVED
	RECONSTRUCTED OVERBRIDGE / UNDERBRIDGE		EXISTING WALL
	OVERBRIDGE / UNDERBRIDGE TO BE DEMOLISHED		FENCES EXISTING
	OVERBRIDGE / UNDERBRIDGE / CULVERTS		FENCES PROJECTED
	TREE or VEGETATION EXISTING		FENCES REMOVED
	TREE or VEGETATION TO BE MAINTAINED		BUILDING TO BE DEMOLISHED
	TREE or VEGETATION TO BE REMOVED		RUNNING LINES/P&C NO CHANGES
	DEVELOPMENT BOUNDARY		PROPOSED SLAB TRACK
	GENERAL SITE CLEARANCE		RUNNING LINES/P&C TO SLEW/REMOVE

REV. DATE	DESCRIPTION	PRODUCED BY	REVIEWED BY	APPROVED BY
V01 April 2022	PLANNING ISSUE	RCA	LAN	CCH

© Irish Rail (2020). This drawing is confidential and the copyright in it is owned by Irish Rail. This drawing must not be either loaned, copied or otherwise reproduced in whole or in part or used for any purpose without the prior permission of Irish Rail.
 © Ordnance Survey Ireland and Government of Ireland. All O.S. data used for plans are printed under "Copyright Ordnance Survey Ireland".
 Survey No. 6039720 (OSI Aerial Data or OSI Lidar Data) & Survey No. 2020051_NMA_180 (OSI Vector Data).
 All elevations are in metres and relate to OSi Geoid Model (OSGM02) Mean Head as defined by existing Project Control.
 All Co-ordinates are in Irish Transverse Mercator Grid (ITM) as defined by OSi active GPS station Tallaght College (TLG9).

Client: Tionscald Éireann Project Ireland 2040

Consultant: IDOM, G3, IROD

Project: DART+ West

Drawing Title: PROJECT GENERAL LAYOUT SITE CLEARANCE ZONE E & F CLONSILLA JCT TO MAYNOOTH DEPOT

Scale: 1:1000 @ A1 1:2000 @ A3

Drawing Number: MAY MDC LMA SC06 DR Y 0001 D

Date: April 2022 Job No: P/101086 Status: F1-Approved & accepted Rev: V01 Sheet: 3 of 26

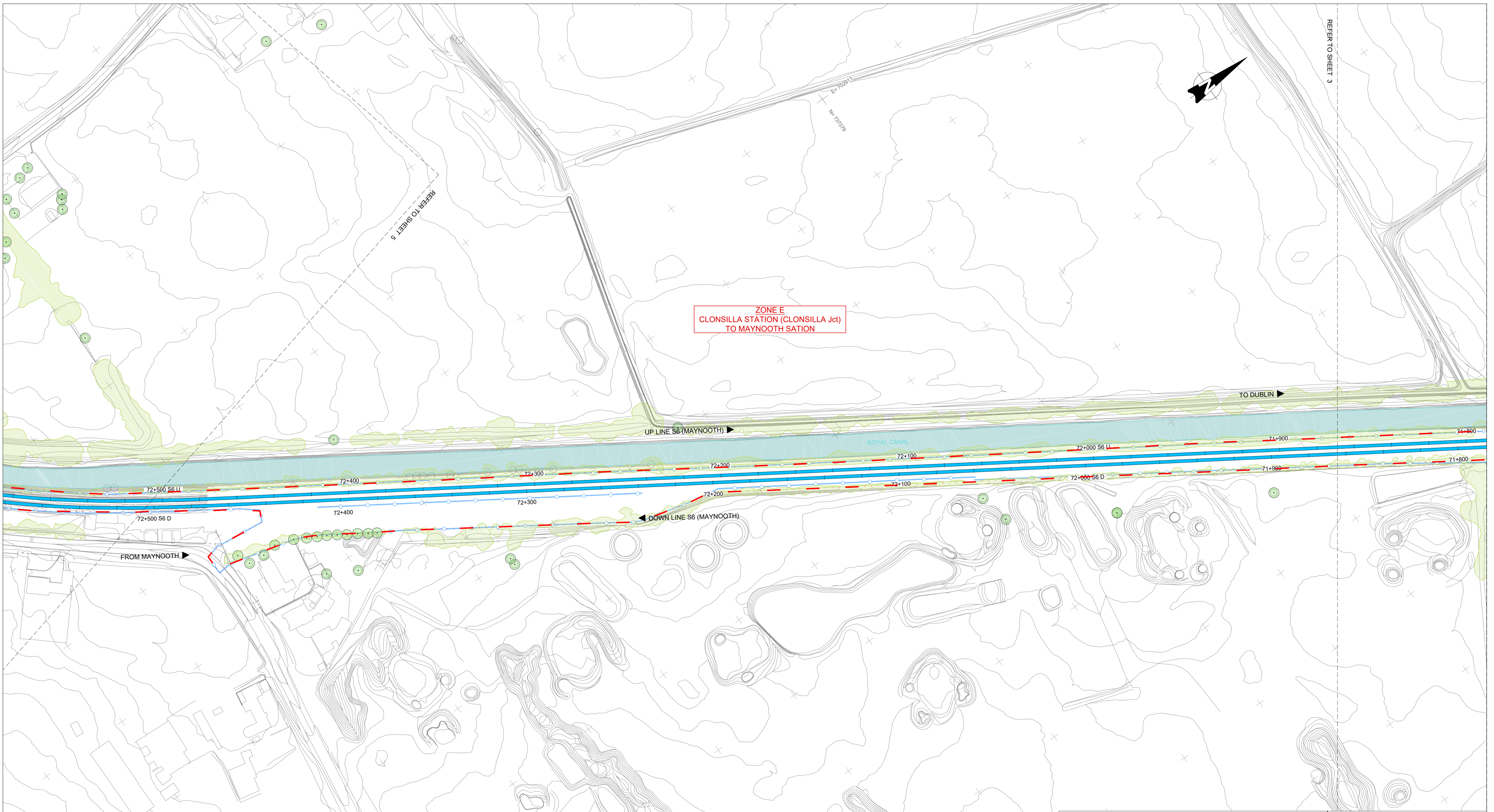

ZONE E
CLONSILLA STATION (CLONSILLA Jct)
TO MAYNOOTH STATION

LEGEND SITE CLEARANCE

	PROPOSED OVERBRIDGE / UNDERBRIDGE		EXISTING GATE TO BE REMOVED
	RECONSTRUCTED OVERBRIDGE / UNDERBRIDGE		EXISTING WALL
	OVERBRIDGE / UNDERBRIDGE TO BE DEMOLISHED		FENCES EXISTING
	OVERBRIDGE / UNDERBRIDGE / CULVERTS		FENCES PROJECTED
	TREE or VEGETATION EXISTING		FENCES REMOVED
	TREE or VEGETATION TO BE MAINTAINED		BUILDING TO BE DEMOLISHED
	TREE or VEGETATION TO BE REMOVED		RUNNING LINES/P&C NO CHANGES
	DEVELOPMENT BOUNDARY		PROPOSED SLAB TRACK
	GENERAL SITE CLEARANCE		RUNNING LINES/P&C TO SLEW/REMOVE

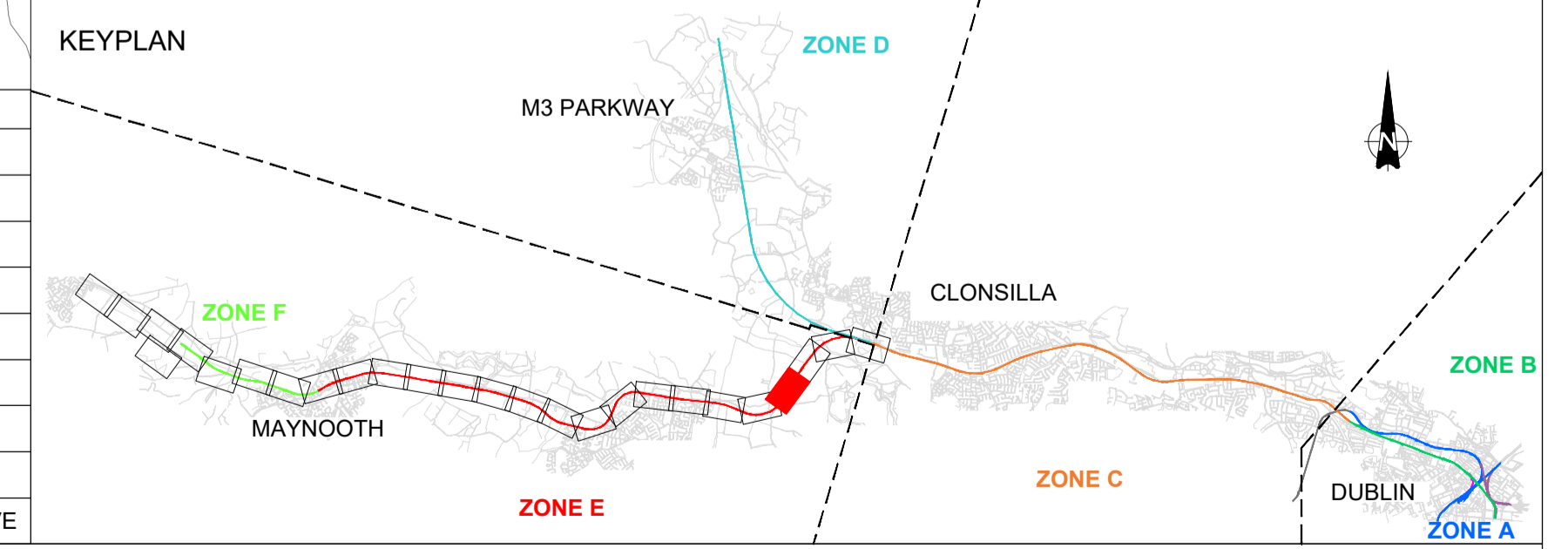

REV.	DATE	DESCRIPTION	RCA	LAN	CCH
V01	April 2022	PLANNING ISSUE			

PRODUCED BY: [] REVIEWED BY: [] APPROVED BY: []

© Irish Rail (2022). This drawing is confidential and the copyright in it is owned by Irish Rail. This drawing must not be either loaned, copied or otherwise reproduced in whole or in part or used for any purpose without the prior permission of Irish Rail.
 © Ordnance Survey Ireland and Government of Ireland. All O.S. data used for plans are printed under "Copyright Ordnance Survey Ireland".
 Survey No. 0039720 (OSI Aerial Data or OSI LIDAR Data) & Survey No. 202005_LMA_100 (OSI Vector Data).
 All elevations are in metres and relate to OSi Geoid Mean (OSGM02) Mean Head as defined by existing Project Control.
 All Co-ordinates are in Irish Transverse Mercator Grid (ITM) as defined by OSi active GPS station Tallaght College (TLG9).

Client: Tionscatal Éireann Project Ireland 2040

Consultant: IDOM, G3, JROD

Project: Iarnród Éireann Irish Rail

Project: DART+ West

Drawing Title: PROJECT GENERAL LAYOUT SITE CLEARANCE ZONE E & F CLONSILLA JCT TO MAYNOOTH DEPOT

Scale: 1:1000 @ A1 1:2000 @ A3

Drawing Number: MAY MDC LMA SC06 DR Y 0001 D

Date: April 2022 Job No: P/101086 Status: Ft-Approved & accepted Rev: V01 Sheet: 4 of 26

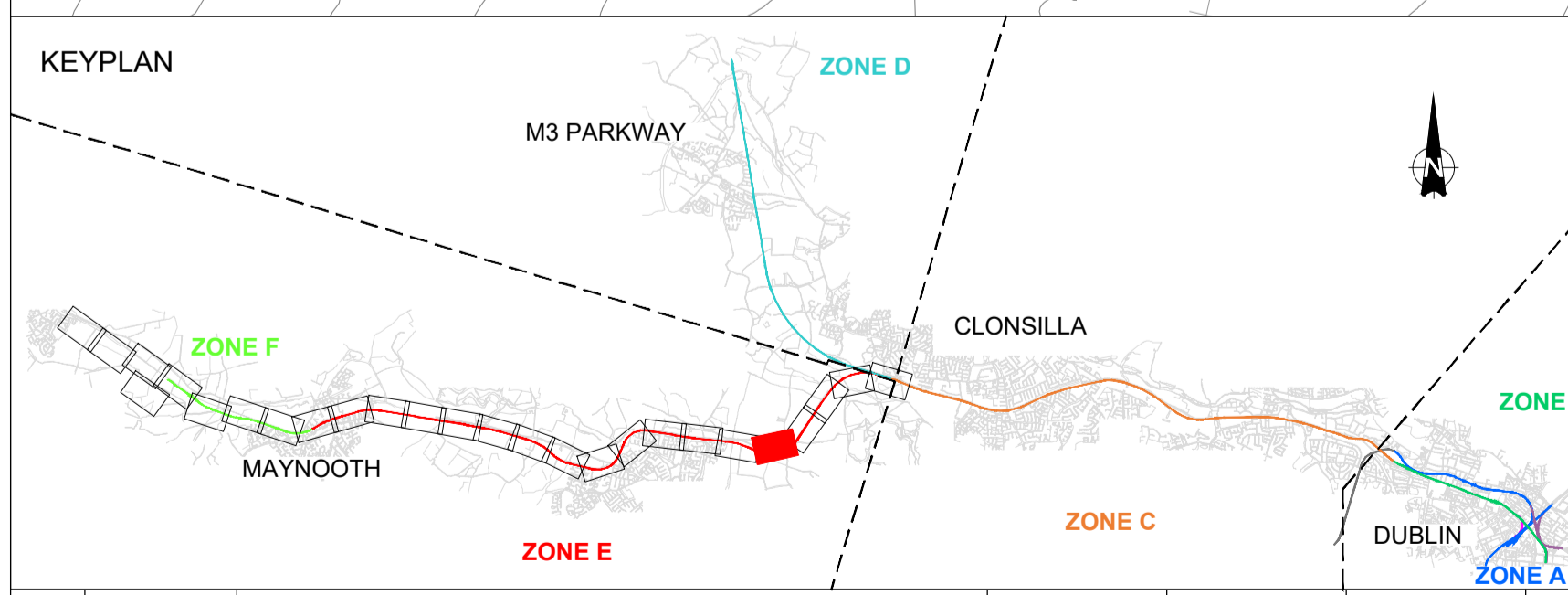
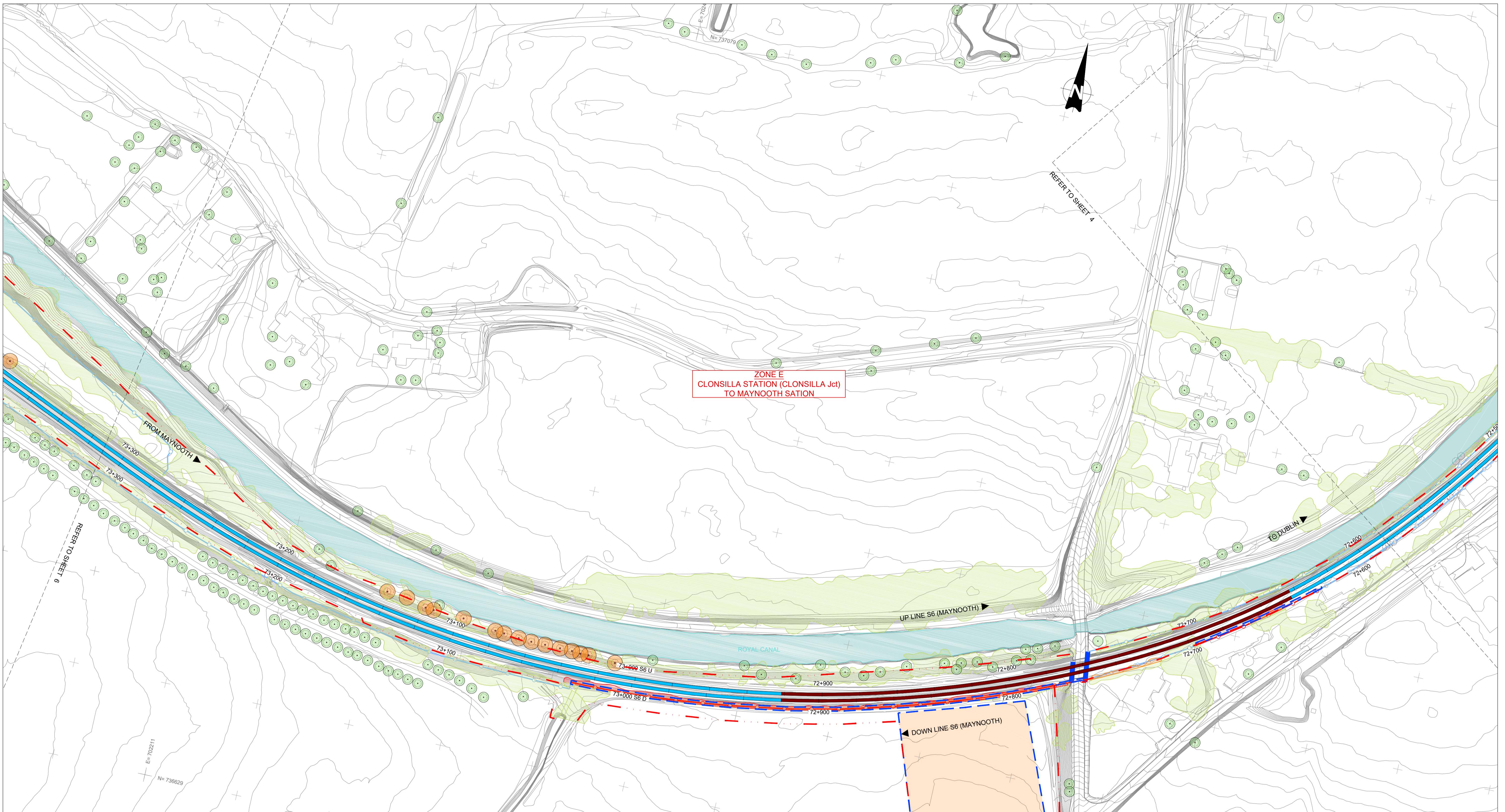

LEGEND SITE CLEARANCE			
	PROPOSED OVERBRIDGE / UNDERBRIDGE		EXISTING GATE TO BE REMOVED
	RECONSTRUCTED OVERBRIDGE / UNDERBRIDGE		EXISTING WALL
	OVERBRIDGE / UNDERBRIDGE TO BE DEMOLISHED		FENCES EXISTING
	OVERBRIDGE / UNDERBRIDGE / CULVERTS		FENCES PROJECTED
	TREE or VEGETATION EXISTING		FENCES REMOVED
	TREE or VEGETATION TO BE MAINTAINED		BUILDING TO BE DEMOLISHED
	TREE or VEGETATION TO BE REMOVED		RUNNING LINES/P&C NO CHANGES
	DEVELOPMENT BOUNDARY		PROPOSED SLAB TRACK
	GENERAL SITE CLEARANCE		RUNNING LINES/P&C TO SLEW/REMOVE

Client	Tionscaldal Éireann Project Ireland 2040	NTA Údaráis Náisiúnta Iompartha National Transport Authority	lanróid Éireann Irish Rail
Project	DART+ West		
Consultant	IDOM	G3	IROD ROUGHAN & O'DONOVAN
REV. DATE DESCRIPTION	RCA	LAN	CCH
V01 April 2022 PLANNING ISSUE			
PRODUCED BY REVIEWED BY APPROVED BY			

© Irish Rail (2020). This drawing is confidential and the copyright in it is owned by Irish Rail. This drawing must not be either loaned, copied or otherwise reproduced in whole or in part or used for any purpose without the prior permission of Irish Rail.
 © Ordnance Survey Ireland and Government of Ireland. All O.S. data used for plans are printed under "Copyright Ordnance Survey Ireland".
 Survey No. 6039720 (OSI Aerial Data or OSI LIDAR Data) & Survey No. 2020051_NMA_190 (OSI Vector Data).
 All elevations are in metres and relate to OSi Geoid Model (OSGM02) Mean Head as defined by existing Project Control.
 All Co-ordinates are in Irish Transverse Mercator Grid (ITM) as defined by OSi active GPS station Tallaght College (TL49).

Drawing Title	PROJECT GENERAL LAYOUT SITE CLEARANCE ZONE E & F CLONSILLA JCT TO MAYNOOTH DEPOT										
Scale:	1:1000 @ A1	1:2000 @ A3	Drawing Number	Project	Originator	Discipline	Location	Type	Role	Number	Phase
			MAY MDC	LMA	SC06	DR	Y	0001	D		
Date:	April 2022	Job No:	P/101086	Status:	F1-Approved & accepted	Rev:	V01	Sheet:	5 of 26		

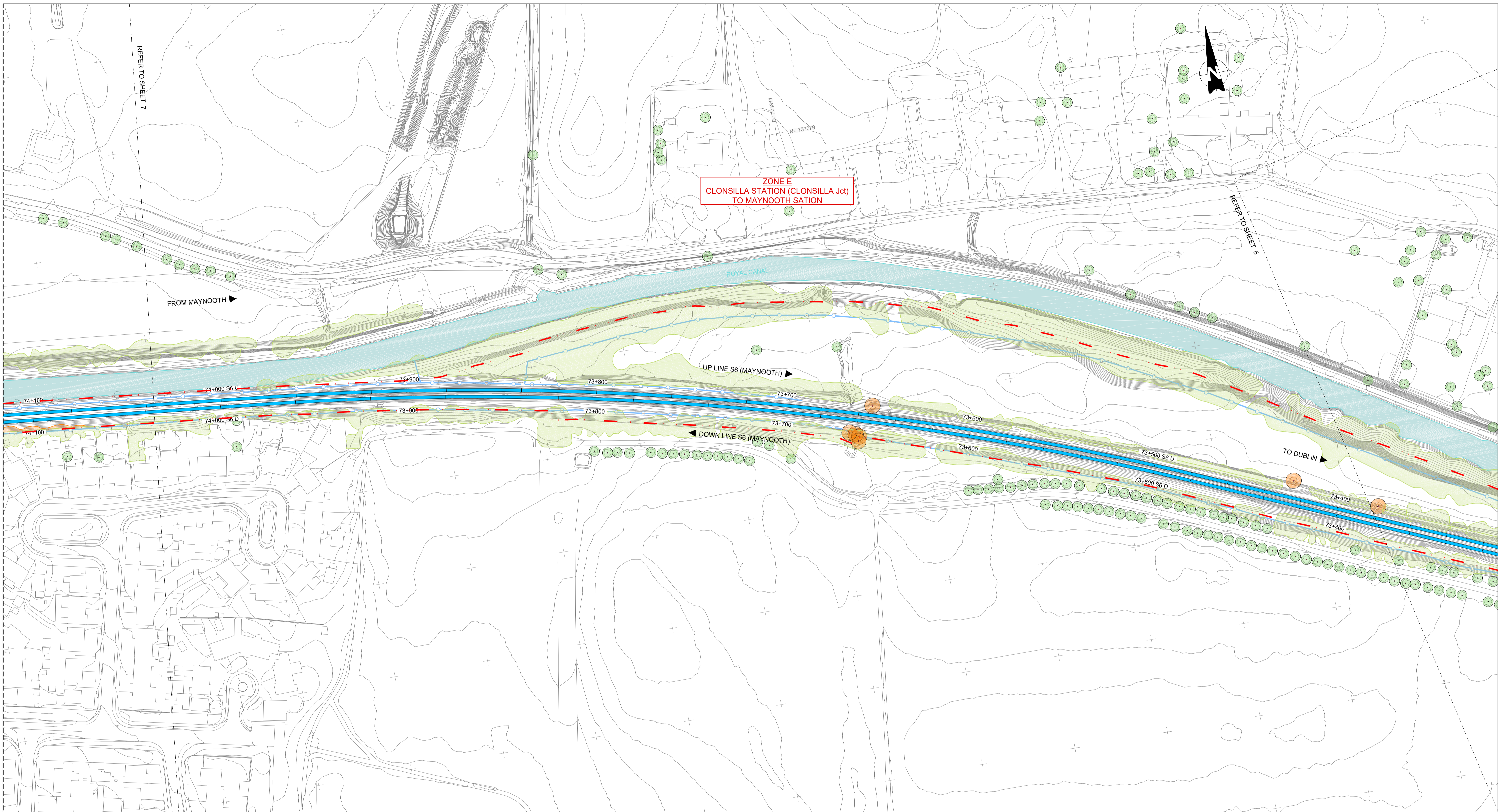

LEGEND SITE CLEARANCE	
	PROPOSED OVERBRIDGE / UNDERBRIDGE
	RECONSTRUCTED OVERBRIDGE / UNDERBRIDGE
	OVERBRIDGE / UNDERBRIDGE TO BE DEMOLISHED
	OVERBRIDGE / UNDERBRIDGE / CULVERTS
	TREE or VEGETATION EXISTING
	TREE or VEGETATION TO BE MAINTAINED
	TREE or VEGETATION TO BE REMOVED
	DEVELOPMENT BOUNDARY
	GENERAL SITE CLEARANCE
	EXISTING GATE TO BE REMOVED
	EXISTING WALL
	FENCES EXISTING
	FENCES PROJECTED
	FENCES REMOVED
	BUILDING TO BE DEMOLISHED
	RUNNING LINES/P&C NO CHANGES
	PROPOSED SLAB TRACK
	RUNNING LINES/P&C TO SLEW/REMOVE

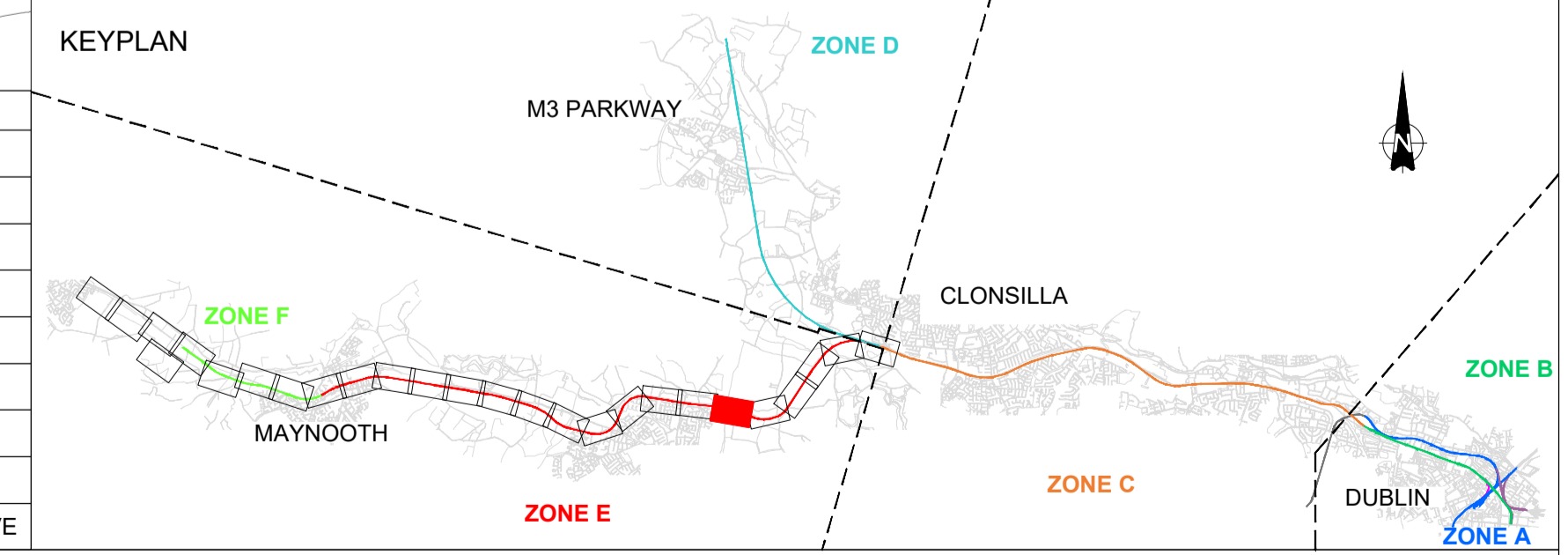

V01	April 2022	PLANNING ISSUE	RCA	LAN	CCH
REV.	DATE	DESCRIPTION	PRODUCED BY	REVIEWED BY	APPROVED BY

© Irish Rail (2022). This drawing is confidential and the copyright in it is owned by Irish Rail. This drawing must not be either loaned, copied or otherwise reproduced in whole or in part or used for any purpose without the prior permission of Irish Rail.
 © Ordnance Survey Ireland and Government of Ireland. All O.S. data used for plans are printed under "Copyright Ordnance Survey Ireland".
 Survey No. 0039720 (OSI Aerial Data or OSI Lxar Data) & Survey No. 0020095_NMA_190 (OSI Vector Data).
 All elevations are in metres and relate to OSi Geoid Mean (OSGM02) Mean Head as defined by existing Project Control.
 All Co-ordinates are in Irish Transverse Mercator Grid (ITM) as defined by OSi active GPS station Tallaght College (TL49).

Client

Tionscaldal Éireann
Project Ireland
2040

NTA
Údarás Náisiúnta Iompair
National Transport Authority

lanróid Éireann
Irish Rail

Consultant

IDOM

G3

PROUD

ROUGHAN & O'DONOVAN

Project

DART+
West

Drawing Title

PROJECT GENERAL LAYOUT
SITE CLEARANCE ZONE E & F
CLONSILLA JCT TO MAYNOOTH DEPOT

Scale:
1:1000 @ A1 1:2000 @ A3

Drawing Number | Project | Originator | Discipline | Location | Type | Role | Number | Phase
MAY MDC LMA SC06 DR Y 0001 D

Date: April 2022 | Job No: P/101086 | Status: Ft-Approved & accepted | Rev: V01 | Sheet: 6 of 26

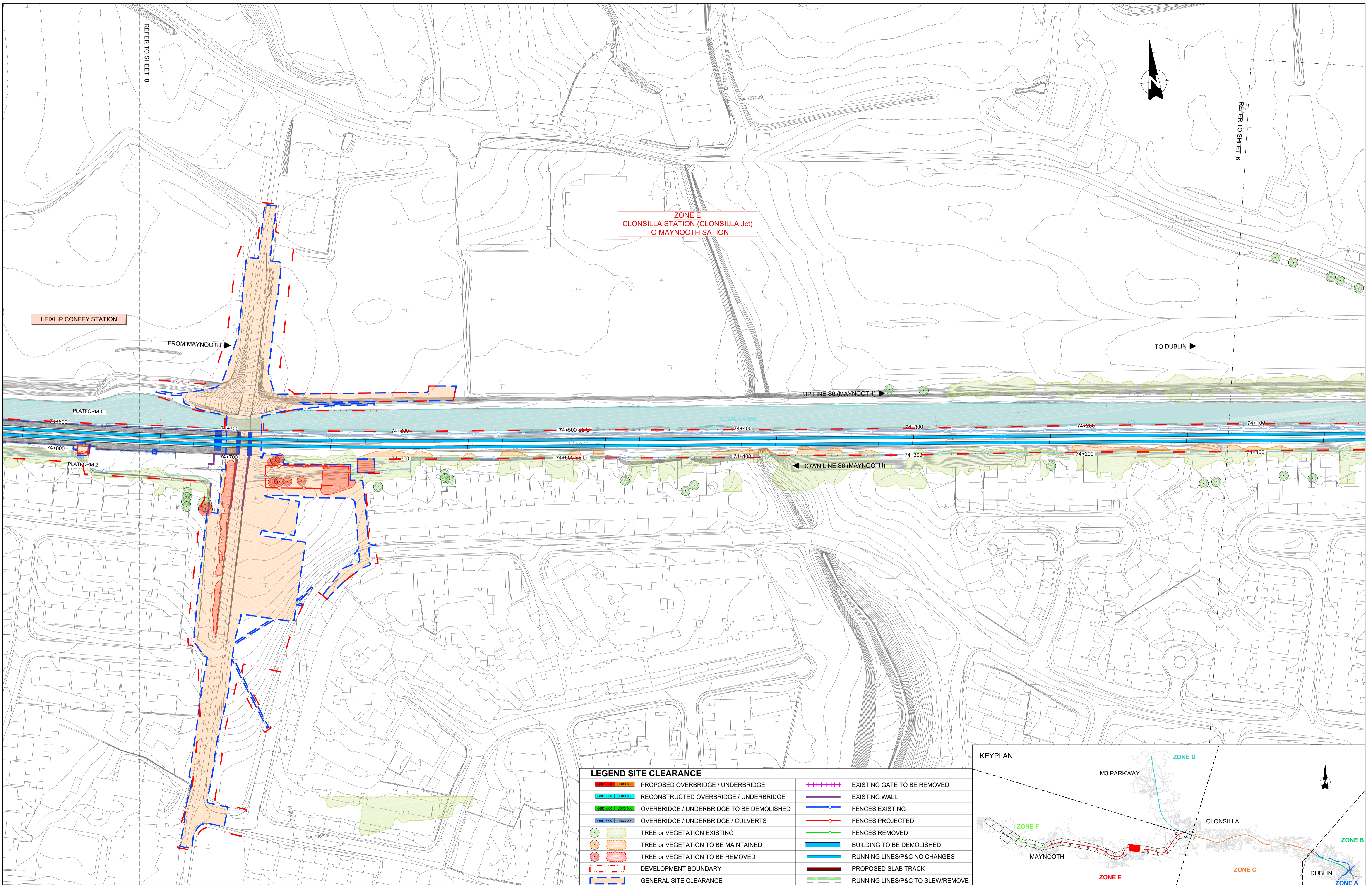

LEGEND SITE CLEARANCE	
	PROPOSED OVERBRIDGE / UNDERBRIDGE
	RECONSTRUCTED OVERBRIDGE / UNDERBRIDGE
	OVERBRIDGE / UNDERBRIDGE TO BE DEMOLISHED
	OVERBRIDGE / UNDERBRIDGE / CULVERTS
	TREE or VEGETATION EXISTING
	TREE or VEGETATION TO BE MAINTAINED
	TREE or VEGETATION TO BE REMOVED
	DEVELOPMENT BOUNDARY
	GENERAL SITE CLEARANCE
	EXISTING GATE TO BE REMOVED
	EXISTING WALL
	FENCES EXISTING
	FENCES PROJECTED
	FENCES REMOVED
	BUILDING TO BE DEMOLISHED
	RUNNING LINES/P&C NO CHANGES
	PROPOSED SLAB TRACK
	RUNNING LINES/P&C TO SLEW/REMOVE

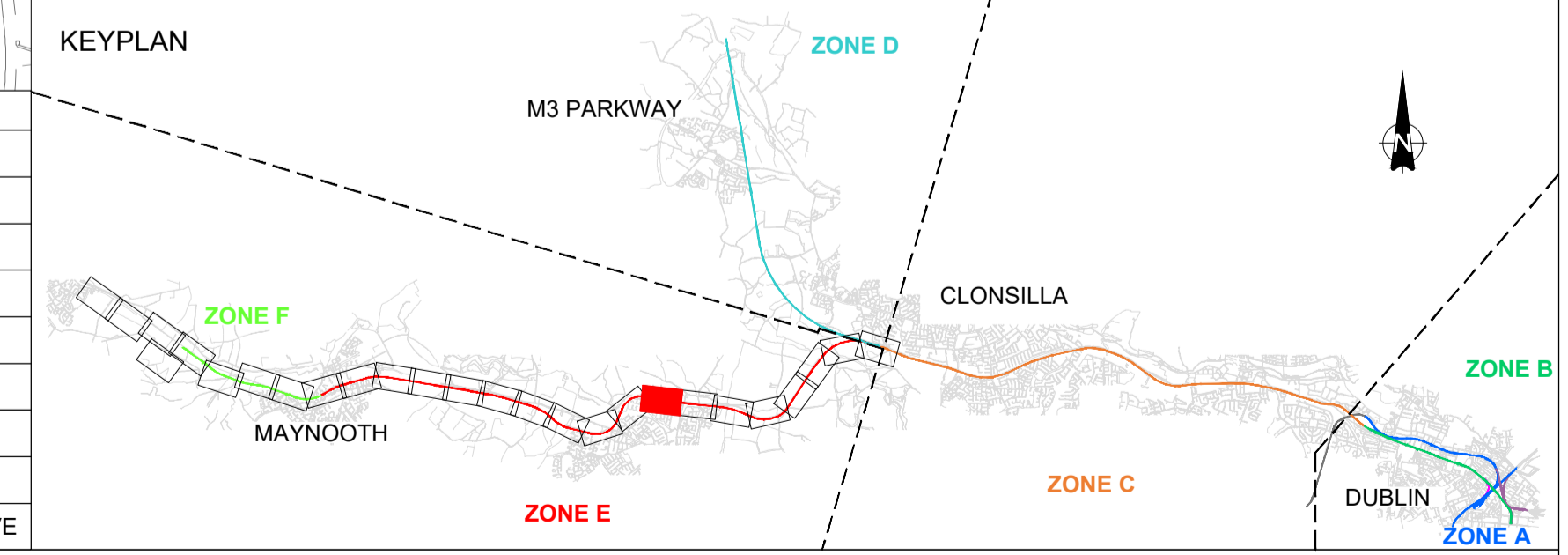

V01	April 2022	PLANNING ISSUE	RCA	LAN	CCH
REV.	DATE	DESCRIPTION	PRODUCED BY	REVIEWED BY	APPROVED BY

© Irish Rail (2022). This drawing is confidential and the copyright in it is owned by Irish Rail. This drawing must not be either loaned, copied or otherwise reproduced in whole or in part or used for any purpose without the prior permission of Irish Rail.
 © Ordnance Survey Ireland and Government of Ireland. All O.S. data used for plans are printed under "Copyright Ordnance Survey Ireland".
 Survey No. 6039720 (OSI Aerial Data or OSI Lidar Data) & Survey No. 2020051_NMA_180 (OSI Vector Data).
 All elevations are in metres and relate to OSi Geoid Mean (OSGM02) Mean Head as defined by existing Project Control.
 All Co-ordinates are in Irish Transverse Mercator Grid (ITM) as defined by OSi active GPS station Tallaght College (TL4,9).

Client

Tionscatal Éireann
Project Ireland
2040

NTA
Údarás Náisiúnta Iompar
National Transport Authority

lanróid Éireann
Irish Rail

Consultant

IDOM

G3

PROJOD
ROUGHAN & O'DONOVAN

Project

DART+
West

Drawing Title

PROJECT GENERAL LAYOUT
SITE CLEARANCE ZONE E & F
CLONSILLA JCT TO MAYNOOTH DEPOT

Scale:
1:1000 @ A1 1:2000 @ A3

Drawing Number | Project | Originator | Discipline | Location | Type | Role | Number | Phase
MAY MDC LMA SC06 DR Y 0001 D

Date: April 2022 | Job No: P/101086 | Status: F1-Approved & accepted | Rev: V01 | Sheet: 7 of 26

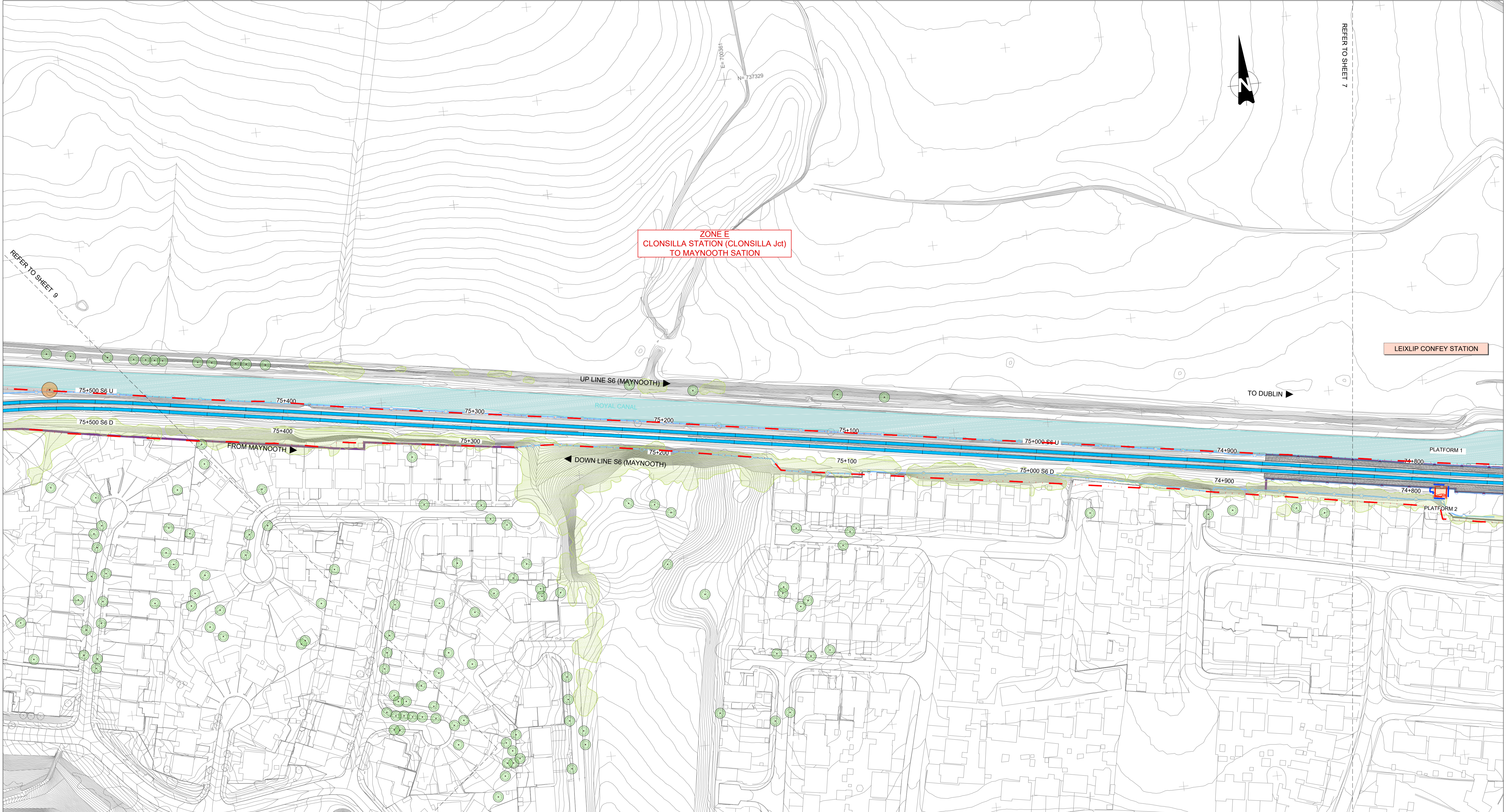

LEGEND SITE CLEARANCE

	PROPOSED OVERBRIDGE / UNDERBRIDGE		EXISTING GATE TO BE REMOVED
	RECONSTRUCTED OVERBRIDGE / UNDERBRIDGE		EXISTING WALL
	OVERBRIDGE / UNDERBRIDGE TO BE DEMOLISHED		FENCES EXISTING
	OVERBRIDGE / UNDERBRIDGE / CULVERTS		FENCES PROJECTED
	TREE or VEGETATION EXISTING		FENCES REMOVED
	TREE or VEGETATION TO BE MAINTAINED		BUILDING TO BE DEMOLISHED
	TREE or VEGETATION TO BE REMOVED		RUNNING LINES/P&C NO CHANGES
	DEVELOPMENT BOUNDARY		PROPOSED SLAB TRACK
	GENERAL SITE CLEARANCE		RUNNING LINES/P&C TO SLEW/REMOVE

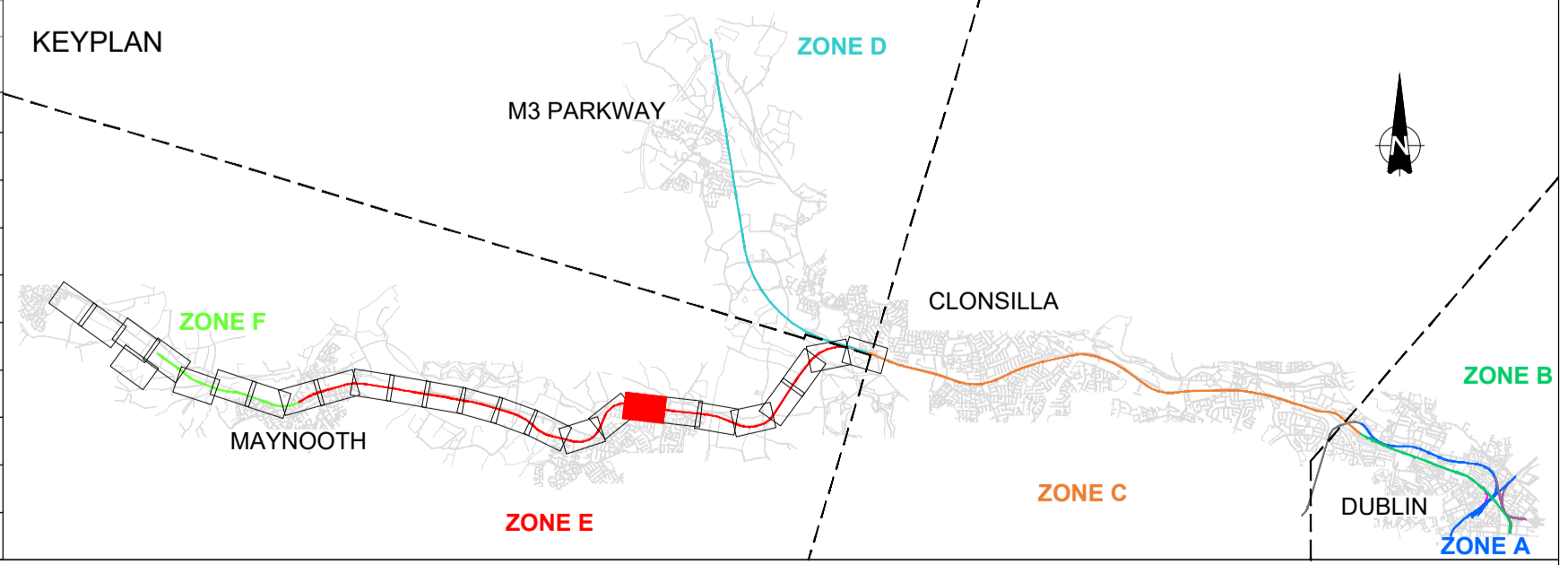

V01	April 2022	PLANNING ISSUE	RCA	LAN	CCH
REV.	DATE	DESCRIPTION	PRODUCED BY	REVIEWED BY	APPROVED BY

© Irish Rail (2020). This drawing is confidential and the copyright in it is owned by Irish Rail. This drawing must not be either loaned, copied or otherwise reproduced in whole or in part or used for any purpose without the prior permission of Irish Rail.
 © Ordnance Survey Ireland and Government of Ireland. All O.S. data used for plans are printed under "Copyright Ordnance Survey Ireland".
 Survey No. 6039720 (OSI Aerial Data or OSI Lxar Data) & Survey No. 2020051_NMA_180 (OSI Vector Data).
 All elevations are in metres and relate to OSi Geoid Mean (OSGM02) Mean Head as defined by existing Project Control.
 All Co-ordinates are in Irish Transverse Mercator Grid (ITM) as defined by OSi active GPS station Tallaght College (TL49).

Client

Tionscaldal Éireann
Project Ireland
2040

NTA
Údarás Náisiúnta Iompair
National Transport Authority

lanróid Éireann
Irish Rail

Consultant

IDOM

G3

PROD

ROUGHAN & O'DONOVAN

Project

DART+
West

Drawing Title

PROJECT GENERAL LAYOUT
SITE CLEARANCE ZONE E & F
CLONSILLA JCT TO MAYNOOTH DEPOT

Scale:
1:1000 @ A1 1:2000 @ A3

Drawing Number | Project | Originator | Discipline | Location | Type | Role | Number | Phase
MAY MDC LMA SC06 DR Y 0001 D

Date: April 2022 | Job No: P/101086 | Status: Ft-Approved & accepted | Rev: V01 | Sheet: 8 of 26